



1090 Bristol Road
Mountainside, NJ 07092
(908) 654-8068
(800) 783-0567
Fax 908-654-8069

LEAD IN DRINKING WATER REPORT

Performed At:

2146 Jacksonville-Jobstown Road
Jobstown, NJ 08041

Performed For:

Springfield Township School District
Shawn Dennis
2146 Jacksonville Jobstown Rd
Jobstown, New Jersey 07047

Prepared By:

LEW Corporation
1090 Bristol Road
Mountainside, NJ 07092

Phone (908) 654-8068
Fax (908) 654-8069
Website <http://www.LEWCorp.com>

Inspection Date: 5/6/2017
Project Number: 170189

Table of Contents

Contact Information	3
Introduction	4
Sampling Methodology	4
Drinking Water Results	5
Recommendations	5

Appendices

Appendix A	Exceedances
Appendix B	Recommendations
Appendix C	All results
Appendix D	Floor Plan(S)
Appendix E	Laboratory Data

Contact Information

Agency

Client Contact:	Shawn Dennis
Client Name:	Springfield Township School District
Street Address:	2146 Jacksonville Jobstown Rd Jobstown, New Jersey 07047
Phone Number:	_____

Risk Assessor(s)

Site Assessor(s):	Mark Franz
License:	NJDOH #003265
Signature:	
Date:	May 22, 2017
E-Mail:	mfranz@lewcorp.com

Firm

Organization:	LEW Corporation
Certification #:	NJDCA 00015 E
Street:	1090 Bristol Road
City, State & Zip:	Mountainside, New Jersey 07092
Phone Number:	908-654-8068
Web Address:	http://www.lewcorp.com

Laboratory

Organization:	Environmental Hazard Services, LLC
Street:	7469 Whitepine Road
City, State & Zip:	Richmond, VA 23237
NJDEP Certification #	VA008
Phone Number:	800-347-4010

Introduction

LEW Corporation was contracted by Springfield Township School District to test for the presence of lead in drinking water in six schools in the district.

Sampling Methodology

LEW Corporation followed the July 13, 2016 amendments to NJAC 6A:26. Full details on sampling practices can be found in Districts Sampling Plan.

All samples were collected in 250mL wide mouth plastic containers that was prepackaged by the analytical laboratory. The sample containers may contain nitric acid, if expedited analysis is required. If not, nitric acid will be added to each sample upon arrival at the laboratory. At each sample location, the first draw sample was taken after it was determined that the water had been standing in the plumbing system for greater than eight hours but less than forty-eight hours. If second draw samples were collected, they were collecting following a flushing protocol outlined in the District's Sampling Plan.

Drinking Water Results

On May 6, 2017, LEW Corporation collected the following number of water samples:

Springfield Elementary

- 18 first draw samples collected
- 0 samples above the 15ppb action level

The complete list of all sample results can be found in Appendix C. The laboratory results can be found in Appendix E.

Certain outlets could not or were not tested due to various reasons. The following table lists those locations and the reason why samples were not collected.

School	Sample Location	Reason for not testing.
None		

Recommendations

All outlets first draw sample tested below 15ppb are not considered to be elevated and no mitigation is necessary.

A complete list of recommendations per outlet can be found in Appendix B.

Additional Recommendations

- 1) Follow-up samples should be collected after any remediation efforts in order to determine the efficacy of the work.
- 2) Any of the inoperable/non-functioning outlets listed above that are brought back into service should be sample.
- 3) Comply with all requirements set forth in NJAC 6A:26.

Appendix A Exceedances

Appendix B Recommendations

Appendix C All Results



Environmental Hazards Services, L.L.C.
 7469 Whitepine Rd
 Richmond, VA 23237
 Telephone: 800.347.4010

Lead in Drinking Water Analysis Report

Report Number: 17-05-01233

Client: LEW Corp
 1090 Bristol Rd
 Mountainside, NJ 07092

Received Date: 05/09/2017
 Reported Date: 05/12/2017
 Sampled By: Mark Franz
 Tech Certification #:

Project/Test Address: 170189; Springfield Twp; 2146 Jacksonville-Jobstown Rd; Jobstown, NJ 08041

Client Number:
 201327

Laboratory Results

Fax Number:
 Ext 18

Lab Sample Number	Client Sample ID	Collection Date	Collection Location	Concentration ug/L (ppb)	Analysis Date	Narrative ID
17-05-01233-001	1-STE-TL	05/06/2017	SINK TEACHERS LOUNGE	1.23	05/11/2017	
17-05-01233-002	2-STE-FP	05/06/2017	SINK KITCHEN	<1.00	05/11/2017	
17-05-01233-003	3-STE-FP	05/06/2017	SINK KITCHEN	6.11	05/11/2017	
17-05-01233-004	4-STE-FP	05/06/2017	SINK KITCHEN	4.73	05/11/2017	
17-05-01233-005	5-STE-DW	05/06/2017	BUBBLER RM 8	4.52	05/11/2017	
17-05-01233-006	6-STE-DW	05/06/2017	BUBBLER RM 9	3.40	05/11/2017	
17-05-01233-007	7-STE-DW	05/06/2017	BUBBLER RM 10	2.28	05/11/2017	
17-05-01233-008	8-STE-DW	05/06/2017	BUBBLER RM 11	5.55	05/11/2017	
17-05-01233-009	9-STE-DW	05/06/2017	BUBBLER RM 12	3.69	05/11/2017	
17-05-01233-010	10-STE-DW	05/06/2017	BUBBLER 64W HALL	9.21	05/11/2017	
17-05-01233-011	11-STE-NS	05/06/2017	SINK NURSE OFFICE	14.9	05/11/2017	
17-05-01233-012	12-STE-WC	05/06/2017	WC 64W HALL	1.22	05/11/2017	
17-05-01233-013	13-STE-WC	05/06/2017	WC 64W HALL	3.10	05/11/2017	

Environmental Hazards Services, L.L.C

Client Number: 201327
Project/Test Address: 170189; Springfield Twp; 2146 Jacksonville-Jobstown Rd; Jobstown, NJ 08041

Report Number: 17-05-01233

Lab Sample Number	Client Sample ID	Collection Date	Collection Location	Concentration ug/L (ppb)	Analysis Date	Narrative ID
17-05-01233-014	15-STE-WC	05/06/2017	WC 93 W HALL	<1.00	05/11/2017	
17-05-01233-015	16-STE-WC	05/06/2017	WC 93 W HALL	<1.00	05/11/2017	
17-05-01233-016	17-STE-WC	05/06/2017	WC 93 W HALL	<1.00	05/11/2017	
17-05-01233-017	18-STE-DW	05/06/2017	BUBBLER, GYM	2.00	05/11/2017	
17-05-01233-018	19-STE-S	05/06/2017	SINK SUN RM	<1.00	05/11/2017	

Method: SM 3113B-2010
Accreditation #: NJ VA008

Reviewed By Authorized Signatory:



Tasha Eaddy
QA/QC Clerk

Sample Results denoted with a "less than" (<) sign contain less than the reporting limit which is 1 ppb.

The EPA Maximum Contaminant Level for Lead in Drinking Water is 15 ppb. The results herein conform to NELAC standards, where applicable, unless otherwise narrated on this report. Results represent the analysis of samples submitted by the client. Sample location, description, field parameter results, etc., were provided by the client. This report cannot be reproduced, except in full, without written approval from Environmental Hazards Services, L.L.C.

LEGEND ug/L= micrograms per liter ppb = parts per billion

Appendix D Floor Plan(s)

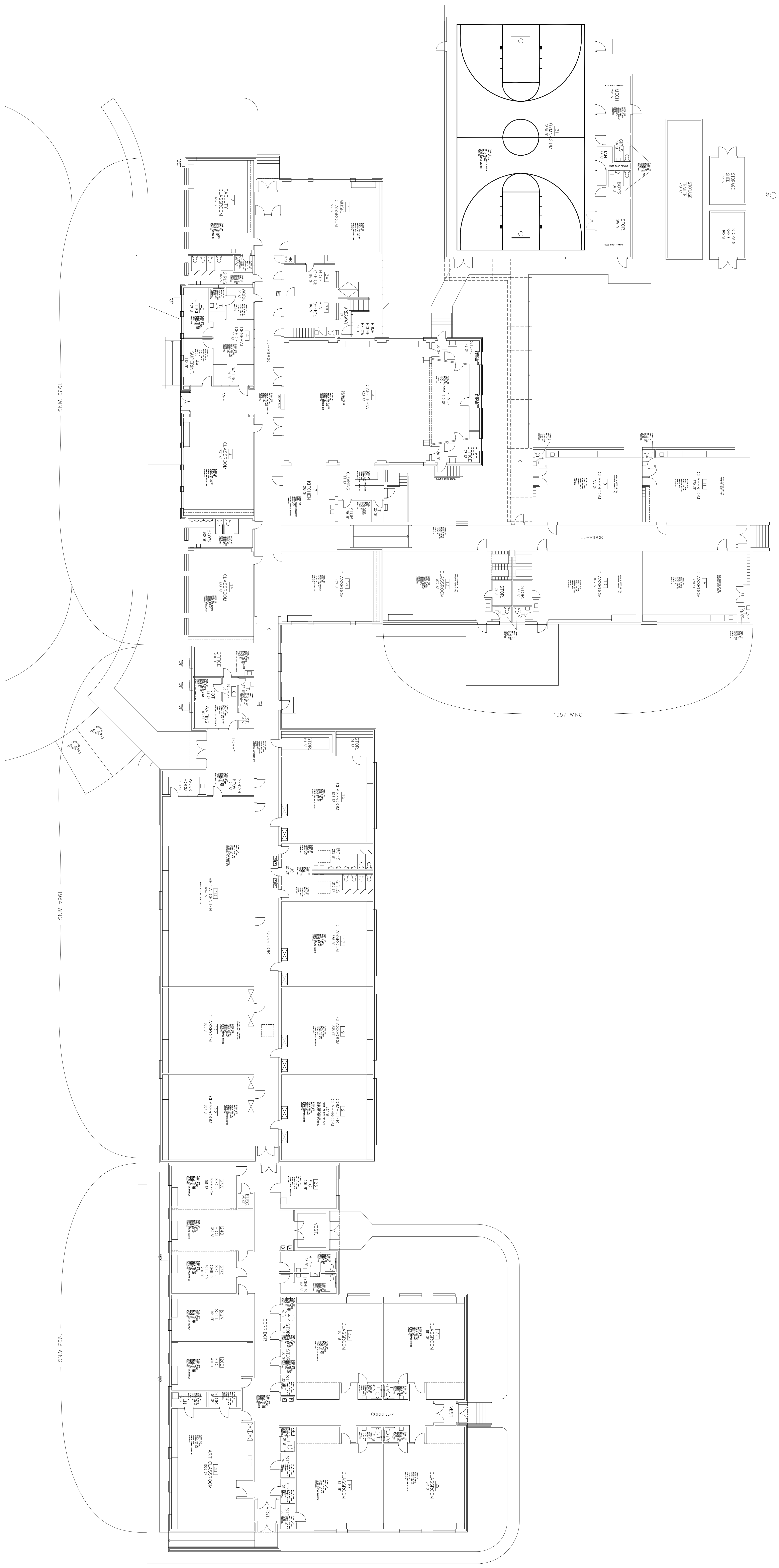

Appendix E Laboratory Data



Environmental Hazards Services, LLC

7469 Whitepine Rd. • Richmond, VA 23237 • 800-347-4010 • jdickerson@leadlab.com

May 12, 2017

LEW Corp
1090 Bristol Rd.
Mountainside, NJ 07092

PROJECT INFORMATION

Project/Test Address: 170189; Springfield Twp; 2146 Jacksonville-Jobstown Rd; Jobstown, NJ 08041

Report Number: 17-05-01233

Analysis Type: Lead – Standard Method 3113B

Lab Accreditation

Number: NJ-VA008/NY-11714

Results, Discussion

Qualifiers: Client sample 14-STE-WC was received empty.

A handwritten signature in blue ink that reads 'Julie Dickerson'. The signature is fluid and cursive, with the first name 'Julie' being more prominent than the last name 'Dickerson'.

Julie Dickerson
Laboratory Administrator
Environmental Hazards Services, LLC



Environmental Hazards Services, L.L.C.
 7469 Whitepine Rd
 Richmond, VA 23237
 Telephone: 800.347.4010

Lead in Drinking Water Analysis Report

Report Number: 17-05-01233

Client: LEW Corp
 1090 Bristol Rd
 Mountainside, NJ 07092

Received Date: 05/09/2017
 Reported Date: 05/12/2017
 Sampled By: Mark Franz
 Tech Certification #:

Project/Test Address: 170189; Springfield Twp; 2146 Jacksonville-Jobstown Rd; Jobstown, NJ 08041

Client Number:
 201327

Laboratory Results

Fax Number:
 Ext 18

Lab Sample Number	Client Sample ID	Collection Date	Collection Location	Concentration ug/L (ppb)	Analysis Date	Narrative ID
17-05-01233-001	1-STE-TL	05/06/2017	SINK TEACHERS LOUNGE	1.23	05/11/2017	
17-05-01233-002	2-STE-FP	05/06/2017	SINK KITCHEN	<1.00	05/11/2017	
17-05-01233-003	3-STE-FP	05/06/2017	SINK KITCHEN	6.11	05/11/2017	
17-05-01233-004	4-STE-FP	05/06/2017	SINK KITCHEN	4.73	05/11/2017	
17-05-01233-005	5-STE-DW	05/06/2017	BUBBLER RM 8	4.52	05/11/2017	
17-05-01233-006	6-STE-DW	05/06/2017	BUBBLER RM 9	3.40	05/11/2017	
17-05-01233-007	7-STE-DW	05/06/2017	BUBBLER RM 10	2.28	05/11/2017	
17-05-01233-008	8-STE-DW	05/06/2017	BUBBLER RM 11	5.55	05/11/2017	
17-05-01233-009	9-STE-DW	05/06/2017	BUBBLER RM 12	3.69	05/11/2017	
17-05-01233-010	10-STE-DW	05/06/2017	BUBBLER 64W HALL	9.21	05/11/2017	
17-05-01233-011	11-STE-NS	05/06/2017	SINK NURSE OFFICE	14.9	05/11/2017	
17-05-01233-012	12-STE-WC	05/06/2017	WC 64W HALL	1.22	05/11/2017	
17-05-01233-013	13-STE-WC	05/06/2017	WC 64W HALL	3.10	05/11/2017	

Environmental Hazards Services, L.L.C

Client Number: 201327
Project/Test Address: 170189; Springfield Twp; 2146 Jacksonville-Jobstown Rd; Jobstown, NJ 08041

Report Number: 17-05-01233

Lab Sample Number	Client Sample ID	Collection Date	Collection Location	Concentration ug/L (ppb)	Analysis Date	Narrative ID
17-05-01233-014	15-STE-WC	05/06/2017	WC 93 W HALL	<1.00	05/11/2017	
17-05-01233-015	16-STE-WC	05/06/2017	WC 93 W HALL	<1.00	05/11/2017	
17-05-01233-016	17-STE-WC	05/06/2017	WC 93 W HALL	<1.00	05/11/2017	
17-05-01233-017	18-STE-DW	05/06/2017	BUBBLER, GYM	2.00	05/11/2017	
17-05-01233-018	19-STE-S	05/06/2017	SINK SUN RM	<1.00	05/11/2017	

Method: SM 3113B-2010
Accreditation #: NJ VA008

Reviewed By Authorized Signatory:



Tasha Eaddy
QA/QC Clerk

Sample Results denoted with a "less than" (<) sign contain less than the reporting limit which is 1 ppb.

The EPA Maximum Contaminant Level for Lead in Drinking Water is 15 ppb. The results herein conform to NELAC standards, where applicable, unless otherwise narrated on this report. Results represent the analysis of samples submitted by the client. Sample location, description, field parameter results, etc., were provided by the client. This report cannot be reproduced, except in full, without written approval from Environmental Hazards Services, L.L.C.

LEGEND ug/L= micrograms per liter ppb = parts per billion



The Environmental CompanySM

LEW Corporation P: (800) 783-0567
1090 Bristol Road F: (908) 654-8069
Mountainside, NJ 07092

Lead

Chain-of-Custody

17-05-01233



Due Date:
05/16/2017
(Tuesday)
AE

Project Name: SPRINGFIELD PROP
Address: 2146 Jacksonville - Jobstown Rd
City, State: Jobstown NJ, 08041
Project Number: 170189

Sample Type Water Standard

Dust wipe Same Day 3 Day
 Paint chip 1 Day Weekend
 Soil

Turn Around Time (TAT)
Name: Mark Franz
Signature: [Signature]

Sample #	Date Collected	Sample Location (Ex: Fl, Kitchen, AC)	Area (inches)	Paint Chip Analysis		
				mg/cm ²	PPM	% wt
1 - STE - TL	5/6/17	Sink, Teachers ^{10th} 1 st Draw	X			
2 - STE - FP		Sink, Kitchen	X			
3 - STE - FP		Sink	X			
4 - STE - FP		Sink	X			
5 - STE - DW		Bubbler, Rm 8	X			
6 - STE - DW		Rm 9	X			
7 - STE - DW		Rm 10	X			
8 - STE - DW		Rm 11	X			
9 - STE - DW		Rm 12	X			

Relinquished by: Mark Franz Signature: [Signature] Date/Time: 5/6/17 5pm

Received by: T. Mahgan Signature: [Signature] Date/Time: 5/9/17 R 3:30



The Environmental CompanySM
 LEW Corporation P: (800) 783-0567
 1090 Bristol Road F: (908) 654-8069
 Mountainside, NJ 07092

Chain-of-Custody

Lead

Water Standard

Lab Use Only:

1233

Project Name: SPRINGFIELD TRIP
 Address: 2146 Jacksonville - Johnston Rd.
 City, State: Johnston NJ 08041
 Project Number: 170189

Sample Type
 Dust wipe
 Paint chip
 Soil
 Turn Around Time (TAT)
 Same Day
 1 Day
 3 Day
 Weekend

Sampler Information
 Name: Mark Figure
 Signature: [Signature]

Sample #	Date Collected	Sample Location (Ex: Fl, Kitchen, AC)	Area (inches)	Paint Chip Analysis		
				mg/cm ²	PPM	% wt
10- STE - DW	5/6/17	Bubbler, 64w Hall, 1st Draw	X			
11- STE - DW NS		Sink, Nurse Office	X			
12- STE - WC		WC, 64w Hall	X			
13- STE - WC		WC, 64w Hall	X			
14- STE - WC		WC, 93w Hall	X			
15- STE - WC		WC, 93w Hall	X			
16- STE - WC		WC, 93w Hall	X			
17- STE - WC		WC, 93w Hall	X			
18- STE - DW		Bubbler, Gym	X			
19- STE - S	5/6/17	Sink, Sump / at # 2607939	X			

* Sample bottle received empty. TAM 5/9/17

Relinquished by: Mark Figure Signature: [Signature] Date/Time: 5/6/17
 Received by: [Signature] Signature: [Signature] Date/Time: 5/9/17 5:30